

Appendix 1 FF plan

- 103/215mm face brickwork
- 100/140/215mm Dense concrete blockwork (Density 1900kg/m³), refer to wall type drawing 876-C330 to 876C-333 for full details on wall make-up and block strength
- Span of beam & block floor over
- CAVITY WALL FIRE STOPPING:
 CB - Cavity barriers to be located at all floor junctions and vertical cavity barriers to be positioned between residential units and as indicated on drawing
- 70/100mm studwork - refer to wall type drawing 876-C330 to 876-C333 for full details on wall make-up
- SVP 34 Soil and vent pipe
- Trapped floor gully
- Automatic opening vent with remote operation at ground floor level to provide min. 1.2m² free open area in accordance with App. Doc B1
- UPVC rainwater pipe
- MU - Movement Joint
- Padstone - sized as per S.E. Dwg's
- Steel beam - as per S.E. Dwg's
- Ceiling mounted extract fan
- Window width
Window height
- Sill 825
(All dimensions to structural faces, sill from FFL)

Notes:
 This drawing is to be read in conjunction with the Structural Engineers' & PC Plank flooring specialist drawings. For all block strength design, steel beams & column sizes & depth refer to Structural Engineers drawings. For all PC Plank sizes & spans refer to specialist GA plans.
 Generally SSL to be 80.025 (U.N.O) through out.
 All blockwork and engineering brickwork to Structural Engineers specifications & details. Refer to Structural Engineers drawings.
 Note: SVP Ducts Soil and vent pipes to be wrapped for full height in min 50mm mineral wool insulation.
 Note: Fire Proofing to Steels
 All steel work to the internal envelope (except roof plates) to be intumescent coated or boxed in 2 No. layers of 15mm Fireline boards to provide 60mins fire resistance.
Fire Compartmentation
 Refer to latest revision of drawings 876-C311, 876-C312, 876-C313, 876-C314 & 876-C315
 All compartments wall to be extended to the underside of the PC planks or taken through roof space to underside of the roof covering.
 Cavity barriers to be located at all floor junctions and vertical cavity barriers to be positioned between residential units and as indicated on drawing.
 Any service penetrations through compartment walls & floors to be fire stopped using appropriate fire collars / dampers fitted on the line of the compartment wall/floor. All to be installed and recorded by fire stopping specialist.

INTERNAL DOOR OPENINGS
 Standard doors:
 726 door - frame size 796x2090
 827 door - frame size 896x2090
 926 door - frame size 996x2090
 1026 door - frame size 1096x2090
 window sill given from FFL

new room numbers	
101	Room 10
102	Room 11
103	Room 12
104	Room 14
105	Room 15
106	Room 16
107	Room 17
108	Room 18
109	Room 19

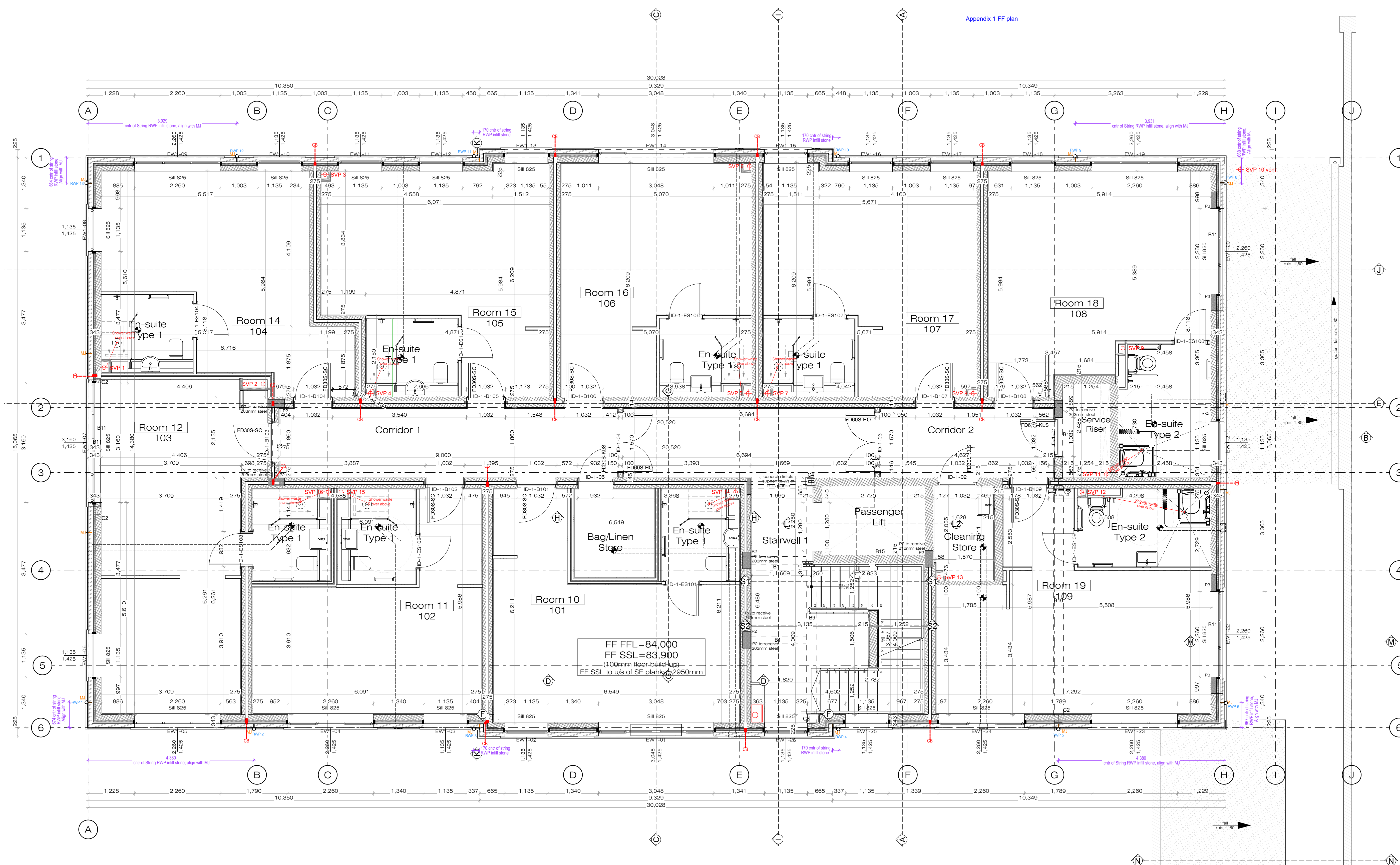

External Wall WT-01 - Render Blockwork, 17N 140mm inner Skin (340mm insulated cavity wall) 20mm Through coloured render system 100mm 7.3N dense concrete blockwork (density 1900/2000kg/m ³) 40mm Clear cavity 60mm Recticell Eurowall PIR insulation 140mm 17N dense block 12.5mm Plasterboard on dabs with 2.5mm skim plaster finish	External Wall WT-03 - Face Brickwork, 17N inner Skin (343mm insulated cavity wall) 103mm Facing brickwork 40mm Clear cavity 60mm Recticell Eurowall PIR insulation 140mm 17N dense block 12.5mm Plasterboard on dabs with 2.5mm skim plaster finish
External Wall WT-02 - Render Blockwork, 17N 100mm inner Skin (300mm insulated cavity wall) 20mm Through coloured render system 100mm 7.3N dense concrete blockwork (density 1900/2000kg/m ³) 40mm Clear cavity 60mm Recticell Eurowall PIR insulation 100mm 17N dense block 12.5mm Plasterboard on dabs with 2.5mm skim plaster finish	External Wall WT-04 - Render Blockwork, 17N 215mm inner Skin (415mm insulated cavity wall) 20mm Through coloured render system 100mm 7.3N dense concrete blockwork (density 1900/2000kg/m ³) 40mm Clear cavity 60mm Recticell Eurowall PIR insulation 140mm 17N dense block 12.5mm Plasterboard on dabs with 2.5mm skim plaster finish

Revisions

Rev	Date	Description	Drawn	Rev	Date	Description	Drawn
C5	Jun23	Courtyard roof added	MP				
C6	Nov23	New room numbers	MP				

Notes
 This drawing is to be read in conjunction with all relevant Structural Engineers' and specialist Sub-contractor's drawings and specifications.
 For the blockwork strength please refer to structural engineer's drawings
 114232-CAL-XX-01-DR-S-202

client
 Platinum Skies

project
 170 Chaminster Road
 Bournemouth
 BH8 9RL

Affordable Housing & Healthcare Group

Hillbrook House
 (former Sherborne Hotel)
 1 Canon Woods Close,
 Sherborne,
 DT9 6FD

This drawing is the copyright of AHH and must not be copied or reproduced without written consent. Use written dimensions only and do not scale. Check all dimensions on site before work proceeds. Report all discrepancies to Architect.

title
 First Floor GA Plan

date 20/11/2023 scale @ A1 1:50 drawn MP checked MP

project ref. 876-C302 revision C6

status CONSTRUCTION date printed: 20/11/2023

